

## GROUP 14 - Electrical cable and insulating sheaths

14.2 - Fiber glass covered electrical nickel cable

### General characteristics

- Continuous working temperatures: -60 °C to +350 °C. Peaks at +400 °C.
- Adequate resistance to thermal shock and UV.
- Excellent ageing resistance.
- Adequate resistance to humidity

### Electrical characteristics

- Working voltage: **500 V**
- Test voltage: **2000 V**.
- Dielectrical strength: **2500 V**.

### Usual applications

- Wiring of heating elements
- Domestic electrical heating appliances
- Commercial cookers and ovens
- Machines for thermoplastics or rubber, etc.

**Packaging:** In coils of 25, 50 or 100 m according to stock.

Code	Colour	Section mm <sup>2</sup>	Øexternal mm	Nº Leads	Ø Lead mm	Weight kg/km	Max current at 320°C Amp.
119057009	WHITE	0,25	1,9	4	0,3	6,5	1,5
119010001	BROWN						
119010006	BLACK	0,5	2,2	7	0,3	8,7	2
119010009	WHITE						
119012001	BROWN	0,75	2,4	11	0,3	11,9	4,5
119012009	WHITE						
119008002	RED						
119008009	WHITE	1	2,5	14	0,3	14,5	5,5
119056007	GREEN+YELLOW (EARTH CONNECTION)						
119013001	BROWN	1,5	2,7	21	0,3	20,5	7
119013012	VIOLET						
119011011	ORANGE	2,5	3,2	35	0,3	32,2	10
119009003	BLUE	4	4	56	0,3	50,1	13,5
119046006	BLACK	6	4,6	84	0,3	72,3	16

## GROUP 14 - Electrical cable and insulating sheaths

14.3 - Silicone covered electrical copper cable

### General characteristics

- Continuous work temperature: from -60°C to +180°C. Peaks up to +230°C.
- Adequate resistance to thermal shocks and to UV
- Excellent ageing resistance.
- Flexible red copper nucleus.
- Silicone rubber type EI2 - HD 22.1.

### Electrical characteristics

- Working voltage: **500 V**
- Test voltage: **2000 V**.

### Usual applications

- Heating wires for electrodomestic items
- Revolving machinery (Class H)
- Lighting items
- Industrial wires in hot atmospheres, etc.

**Packaging:** In coils of 100 or 200 m according to stock.

Code	Colour	Section mm <sup>2</sup>	Øexternal mm	Nº Leads	Ø Lead mm	Weight kg/km	Max. linear resistance at 20 °C W/km
119001009	WHITE	0,75	2,3	24	0,2	11,5	< 26
119002009	WHITE	1	2,5	32	0,2	14,2	< 19,5
119056003	BLUE						
119056005	RED BRICK	1,5	2,8	30	0,25	19,8	< 13,3
119056009	WHITE						
119004003	BLUE						
119004005	RED BRICK	2,5	3,4	50	0,25	30,7	< 7,98
119004009	WHITE						
119005001	BROWN						
119005006	BLACK	4	4,2	56	0,3	48	< 4,95
119005009	WHITE						
119006001	BROWN						
119006005	RED BRICK	6	5,2	84	0,3	72,8	< 3,30
119006006	BLACK						

## GROUP 15 - Magnetic anti-calcium

15.1 - Magnetic anti-calcium that reduces corrosion



This is a revolutionary system for the conditioning of drinking water. By means of a magnetic field, it reduces the sedimentation speed of the calcium contained in water and changes the type of crystalline structure while reducing the thickness and type of calcium deposited on resistors, tubing, tap sprayers, hand-held shower heads, etc., keeping the passage of water clear and diminishing the effects of interstitial corrosion caused by calcium sediments.

Model	Code
STANDARD FOR PIPES (In blister pack)	575005000

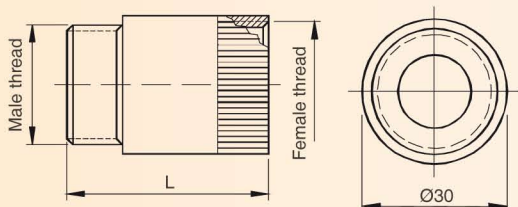

Model	Code	BSP Thread		L in mm
		Male	Female	
FOR SHOWERS	575002000	R 1/2"	R 1/2"	42
FOR WASHING MACHINES	575003000	R 3/4"	R 3/4"	44
FOR DISHWASHER	575004000	R 3/4"	R 3/4"	44

The **STANDARD** Magnetic Anti-Calcium Systems are for installation on the outside of copper, iron, plastic and other types of pipes. The pipe does not need to be cut and the water flow need not be interrupted. The installation may be performed manually without the help of tools. The benefits of the magnetic field are effective within an area of approximately 30 meters from the installation point. If a pump is installed on the line, the effect disappears, so another unit must be installed at the discharge of the pump.

If this product is installed at the water intake, corrosion is reduced. While corrosion is not completely eliminated for some types of water, in most cases the service life of resistors, tanks and pipes is effectively extended.

The **SHOWER** model is for installation between the outlet thread of the tap and the hand-held shower head thread, and in the other two models (**WASHING MACHINE** and **DISHWASHER**), between the outlet thread of the tap and the hose thread of the washing machine or dishwasher.

**NOTE:** Nowadays it is fashionable to magnetize water for therapeutic and other uses. SANTI ESCOIN only has equipment to verify the improvement with respect to corrosion and reduction of calcium sediments, so we cannot provide advice on other applications. To determine the effect of this product on other characteristics of water, we recommend that a specialized technical expert be contacted.